

02.15.2023

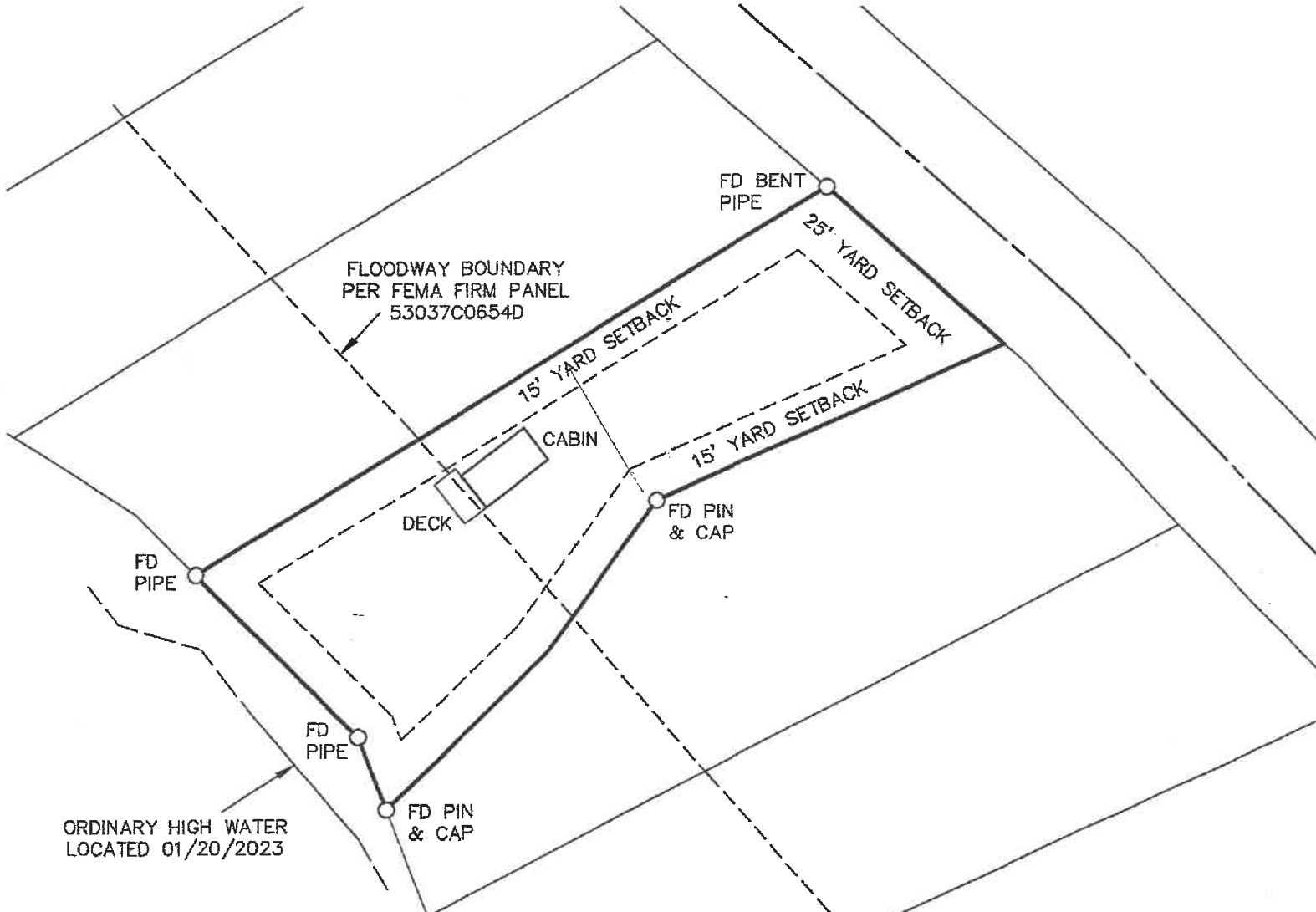

**SPORAR PROPERTY**  
521 HERON DRIVE CLE ELUM, WA 98922  
TAX PARCEL NO. 310634

SCALE: 1" = 60'



ORDINARY HIGH WATER  
LOCATED 01/20/2023

NOTE: INFORMATION SHOWN  
HEREON IS BASED ON FIELD  
LOCATES COMPLETED  
JANUARY 20, 2023.

**SURVEYOR'S CERTIFICATE**

I HEREBY CERTIFY THAT THE  
INFORMATION SHOWN HEREON  
IS BASED ON THE ACTUAL  
SURVEY AND IS CORRECT.

CHRISTOPHER C. CRUSE  
Professional Land Surveyor  
License No. 36815

2/14/2023

DATE

